

**D**

DISTRIBUTABLE

THIS DRAWING AND DESIGN HEREON  
CONSTITUTES A PROPRIETARY DESIGN  
OF M&H ELECTRIC FABRICATORS, INC.  
AND IS NOT TO BE DUPLICATED OR  
REPRODUCED WITHOUT AUTHORITY OF  
M&H ELECTRIC FABRICATORS, INC.

## CONVERSION FROM EXTERNAL TO INTERNALLY REGULATED ALTERNATOR

REVISIONS			
DATE	REV.	DESCRIPTION	APPR. BY
02-06-22	B	UPDATED FOR CLARITY AND RELEASED AS REV B.	909

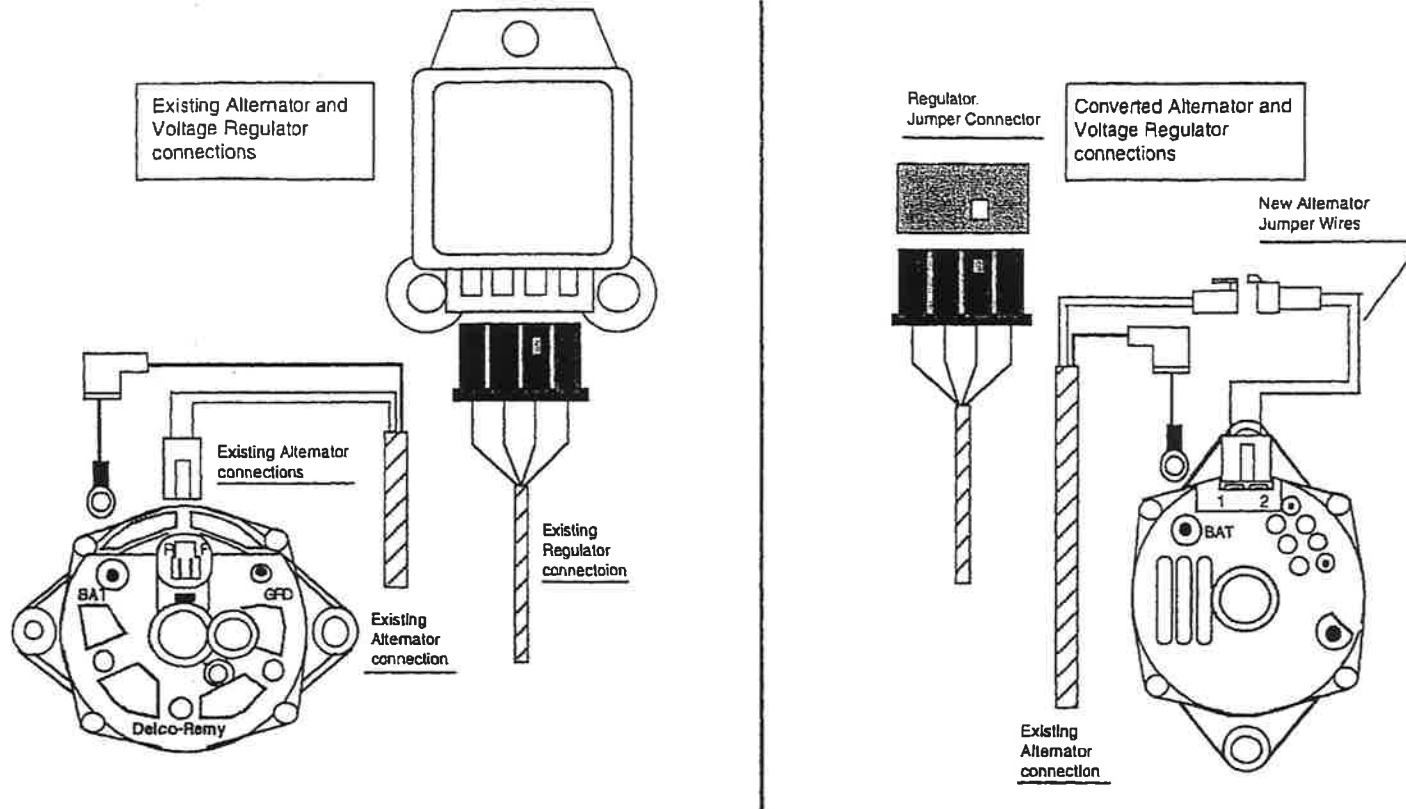

### INSTALLATION INSTRUCTIONS

1. Before attempting any modifications involving the charging system, the battery should be disconnected.
2. Unplug the 2 place connector from the existing alternator and plug it into the new alternator jumper wires mating connector.
3. Unbolt the power lead wire from the existing alternator and remove the old alternator from the car.
4. Install your new internally regulated alternator. Plug in the 2 place connector on the new alternator jumper wires and bolt the alternator power wire to the "BAT" post.
5. Make sure that the alternator is properly grounded. In most cases the alternator is grounded through the engine block to the frame. However, this is not always true. If in doubt, a ground wire can be installed from the alternator case ground bolt to a good chassis ground.
6. Unplug the 4 place connector from the external voltage regulator and plug it into the supplied regulator jumper connector.
7. Remove the existing voltage regulator from the car.
8. Reconnect the battery.

**M&H ELECTRIC FABRICATORS, INC.**  
AUTOMOTIVE WIRING SYSTEMS  
(562) 926-9552 www.wiringharness.com

DATE: 02-06-22	REFERENCE NO. 27555	SHEET NO. 1 OF 2
-------------------	------------------------	---------------------

TITLE  
**INSTRUCTION SHEET  
ALTERNATOR CONVERSION HARNESS**

PART NO.

**92963347**